



250 Series

Two and Four Button Radio Remotes

The '250 Series' Two and Four Button Radio Remotes are a compact design for use with Automatic Gates, Garage Doors, Car Turntables and other products requiring a remote radio control



Performance Required	250K-SLIM	250T-4	250K-SLIMRP	250T-4RP
Range	Approximately up to 200 metres in the open (the effective range depends on terrain, Antenna quality and possible radio interference)			
Frequency	433.92MHz (± 100kHz)			
Radio Coding	Dip-switch 1,024 codes		Rolling Code	
Battery	2 x CR2016			
Estimated Battery Life	Approx. 2 years, with 10 operations per day			
Protection Degree	IP44			
Operating Temp	-20 ⁰ – +55 ⁰ c			
LED Colour	Red		Green	
Ordering Code	250K-SLIM	250T-4	250K-SLIMRP	250T-4RP

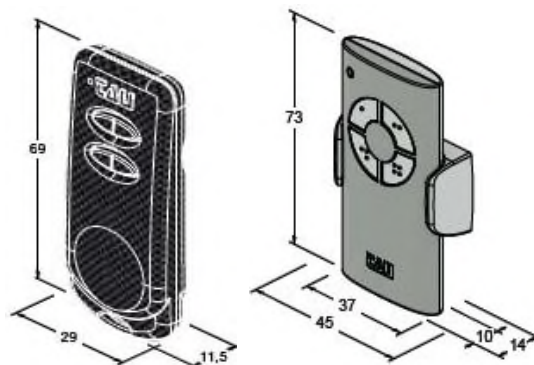

**250K-SLIM
250K-SLIMRP**

**250T-4
250T-4RP**

Dimensions

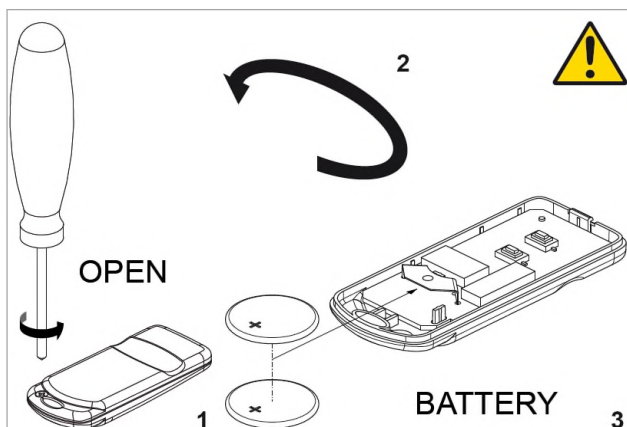

250K-SLIM & 250K-SLIMRP

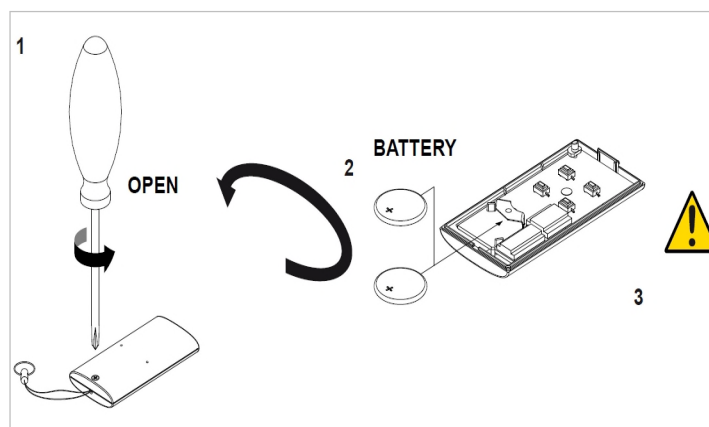

250T-4 & 250T-4RP



ATTENTION: Ensure the Batteries are replaced with the correct ones, (2 x CR2016) as failure to do so may cause an explosion.

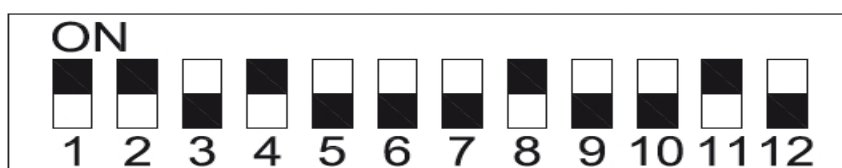

DIP SW 1-10 Programmable Code
DIP SW 11 Not Available
DIP SW 12 (ON) Higher Range
DIP SW 12 (OFF) Longer Battery Life



250 Series

One, Two and Four Channel 433.92 MHz Radio Receivers



The '250 Series' One, Two and Four Channel Radio Receivers are a compact design for use with Automatic Gates, Garage Doors, Vehicle Turntables and other products requiring a remote radio control

PRODUCT	FEATURES	NUMBER OF CHANNELS	MEMORY/CODES ROLLING CODES ONLY	INPUT VOLTAGE	POTENTIAL FREE CONTACT OUTPUT	MAX. OUTPUT RATING 0.5Amp 30V DC	FIXED PULSE MODE (Approx. 1-2 seconds)	SUSTAINED PULSE/DELAY MODE	BI-STABLE (Step-by-step) MODE
	250RXSM1B	1	14*	12-24V ac/dc	YES	3A	YES	YES**	YES***
	250RXSM2B	2	14*	12-24V ac/dc	YES	3A	YES	YES**	YES***
	250RXDC4	4	62*	12-24V ac/dc	YES	3A	YES	YES**	YES***
	250RXDC4T	4	62*	230V ac	YES	3A	YES	YES**	YES***
	250ANTD1	Tuned Antenna with bracket for 433.92MHz Radio Receivers with a 4 metre lead							

***Code Limitations:** The 14 Memory Slots are across the 2 Channels of the Dual Channel Receivers.
The 62 Memory Slots are across the 4 Channels

**** Timed Mode:** The Output relay contact closes for approx. 3 minutes (cannot be varied)

***** Bi-stable or Step-by-step mode:** At each impulse given by the Radio Remote, the output relay contact changes its logic state: closed-open, open-closed.....